

Construction Materials / Thicknesses

- 80mm concrete block paviours in herringbone 45° laying patters
- 30mm 0-6mm sand laying course
- 130mm CBGM (Cement-Bound Granular Material) C5/6
- 150mm Type 1 sub base material
- 200mm 6F2/6F5

Type A  
Adopted Highway Non-Permeable Block Paving  
Vehicular Access

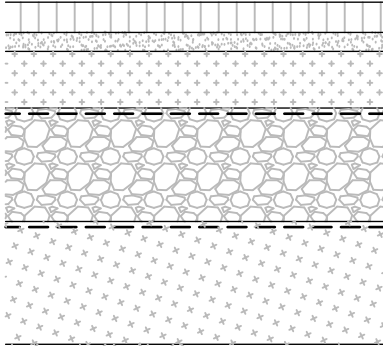

Construction materials / thicknesses

- 80mm clay paving in herringbone 45° laying patters
- 50mm thick 2-6mm open graded crushed rock
- Geotextile
- 150mm CBGM (Cement Bound Granular Material) C5/6 core drilled 75mm holes at 780mm centres and backfilled with laying course material 2-6mm open-graded crushed rock
- 300mm 4-20mm open graded crushed rock
- Impermeable membrane

Type C  
Private Permeable Block Paving with storage sub-base  
Vehicular Access  
Based on interpave guidance

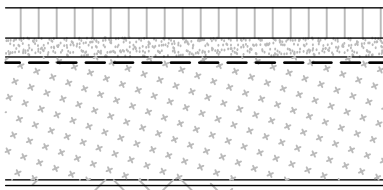

Construction materials / thicknesses

- 200 x 65 x 80mm clay paving in herringbone 45° laying pattern
- 30mm thick class 3 sand laying aggregate
- Geotextile
- 300mm Type 1 sub-base
- Impermeable membrane

Type D  
Private Non-permeable Blocked Paving  
Pedestrian Access

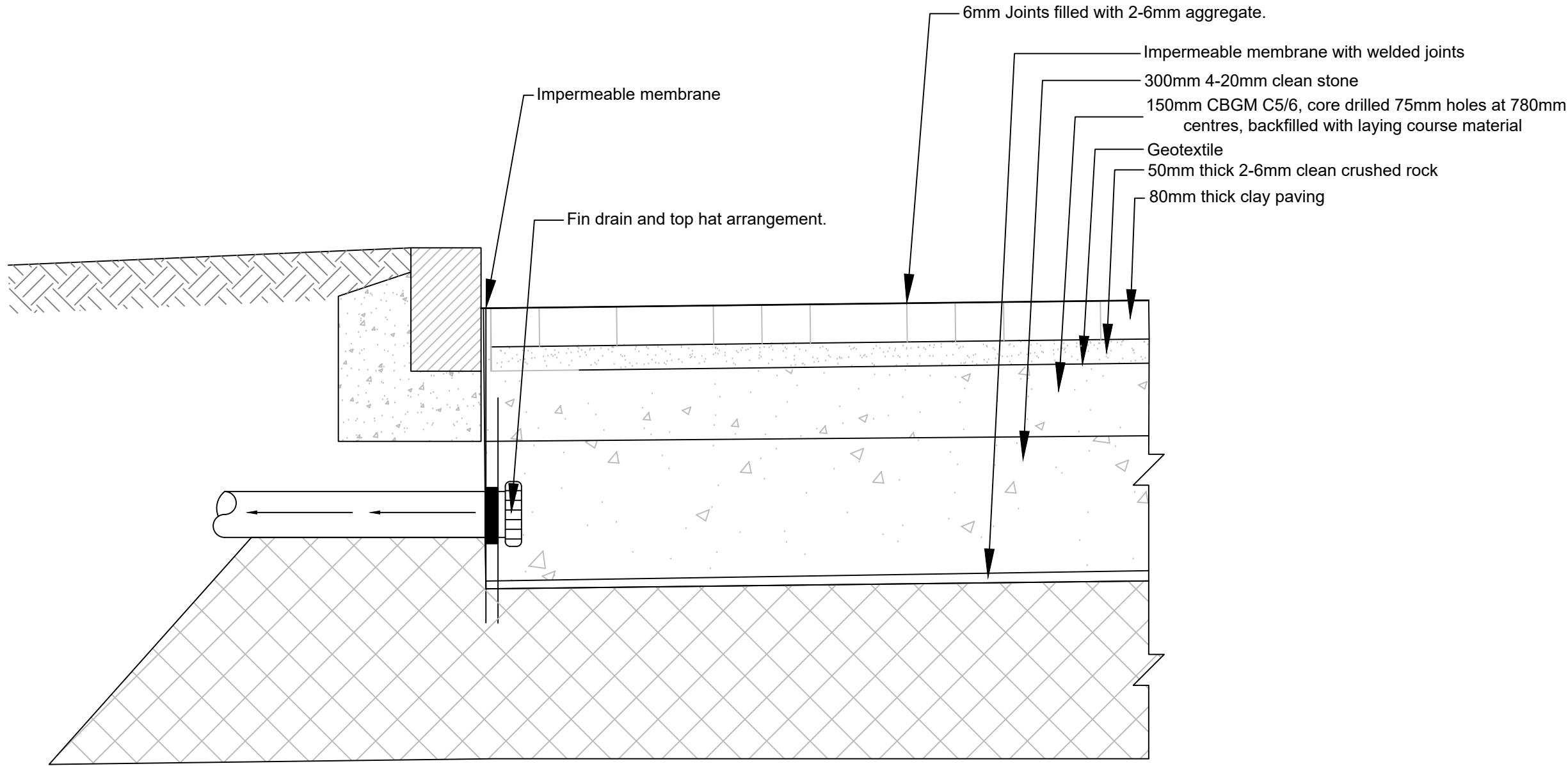

Tanked permeable paving with Fin drain connection  
SCALE 1:10

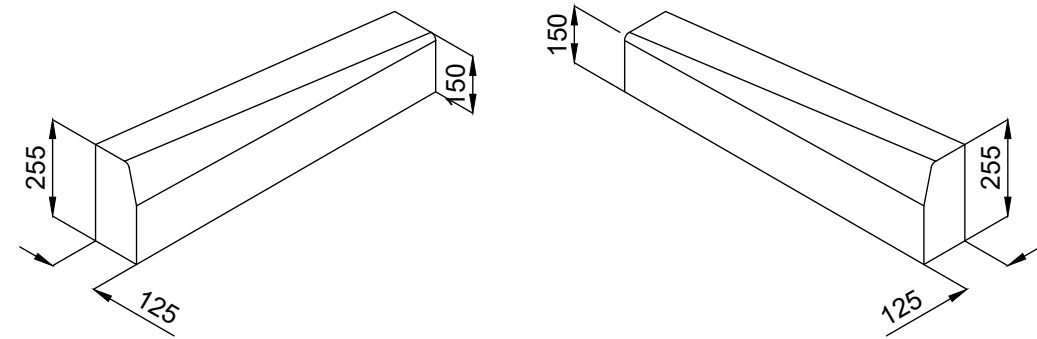

Left Hand Transition DL

Right Hand Transition DR

Transition kerbs DL1 and DR1  
HB2 to BN  
255 to 150  
Scale 1:20

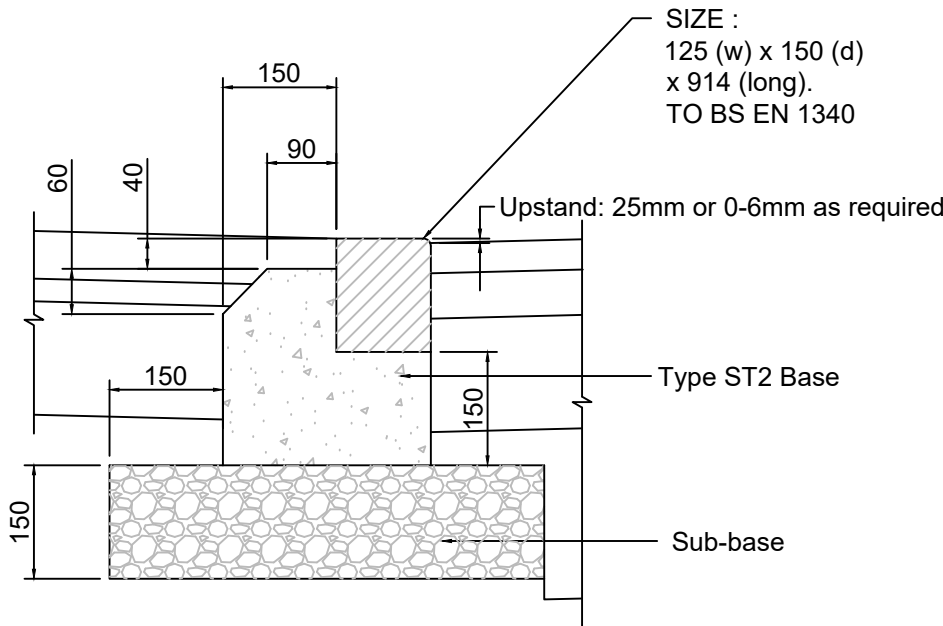

Bullnosed Kerb  
Type BN  
SCALE 1:10

Where BN Kerb is flush to surface, Kerb is to be inverted with 0mm Upstand

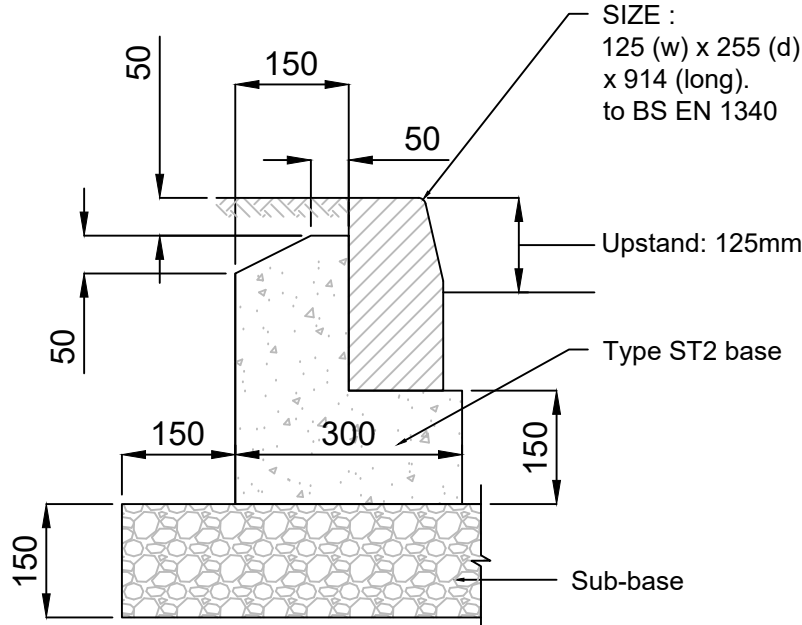

Full height kerb type HB2  
SCALE 1:10

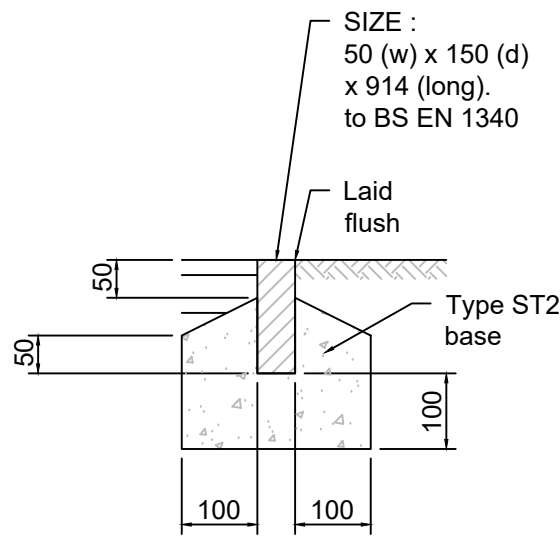

Edging type EF flat top  
SCALE 1:10

Notes

- Do not scale from this drawing on print or electronically. Work from figured dimensions only.
- No deviation from the details on this drawing is allowed without CampbellReith's prior permission in writing.
- Read this drawing with all Architect's, Service Engineer's and CampbellReith's relevant details, specifications and drawings.
- All work is to be done in accordance with the relevant specifications issued by CampbellReith, British Standard Codes of Practice, Statutory Requirements and the Contract Documents.
- Drawing revision:**  
**P: Preliminary** Evolving drawings for approvals, tenders, billings etc.  
**C: Contractual** Drawings authorized and approved for stage completion i.e. Stage-Tender or Stage 5-Construction.
- Drawing status:**  
*Work in progress*  
**S0** - Initial status  
*Shared (Non-contractual)*  
**S1** - Suitable for coordination, **S2** - Suitable for information, **S3** - Suitable for review and comment, **S4** - Suitable for stage approval.  
*Published (For contractors purposes)*  
**A1, An** etc - Authorised and accepted ('n' relates to work stages)  
**B1, Bn** etc - Partial sign-off (with comments)  
**CR** - As constructed record document (Final Construction ONLY. Any deviations to that which is on site is not the liability of CampbellReith)
- Work Stages:**  
**2** - Concept, **3** - Definition, **4** - Design, **5** - Build & commission, **6** - Handover
- Only drawings with **revision Cn** and **status A5** to be used for Construction.
- Pavement construction based on a minimum CBR of 3%. Contractor is to report findings to engineer.

P1	Issued for information	19.11.25	NB
Rev	Description	Date	By

CampbellReith  
consulting engineers

London	020 7340 1700	<input type="checkbox"/>	Manchester	0161 819 3060
Surrey	01737 784 500	<input type="checkbox"/>	Birmingham	01675 467 484
Bristol	0117 916 1066	<input checked="" type="checkbox"/>	Dubai	00 971 4345 7088
www.campbellreith.com				

Job Title	Ennor Farm
Client	The Council of the Isles of Scilly

Pavement Construction Details

Drawn by	Date made	Scale @ A1	Checked by	Suitability	CR Project
NB	13.11.25	A.S.	LM	S2	13847

Project No.	Originator	Volume	Lvl/Loc	Type	Role	Number	Rev
13847	CRH	P1	SA	DR	C	5350	P1